

INDEX LEGEND

SURVEYOR'S NAME/RETURN TO:  
MIKE SCHULTE, SCHULTE SURVEYING, INC.  
2003 390TH STREET  
WESTSIDE, IA 51467  
712-790-3489  
MIKE@SCHULTESURVEY.COM  
REQUESTED BY:  
KEN NEPPLE  
OWNER:  
NEPPLE INC,H J & C T  
SURVEY LOCATED:  
LOT 1 NW1/4 NE1/4  
SEC 31, T84N, R37W, CRAWFORD COUNTY, IOWA  
SURVEY DATE: 2018/08/22

PLAT OF SURVEY  
LOT 1 OF THE NW1/4 NE1/4 SECTION 31, T84N, R37W



NE COR NWNE  
SEC 31-84-37  
FND 5/8" OPC 17048  
TIES OK

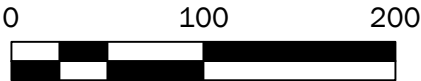

BASIS OF BEARING

1aRCS ZONE 6 - US SURVEY FEET  
1aRTN DERIVED - NAD83(2011)(EPOCH 2010.00)  
FOUND/CALCULATED COORDINATES

POINT	NORTHING	EASTING
1	7256638.35	16645435.56
2	7256633.84	16646737.78
3	7254021.68	16645399.63
4	7256637.47	16645690.56
5	7256604.47	16645690.10
6	7256447.48	16645687.95
7	7256370.53	16645675.89
8	7256370.77	16645605.89
9	7256197.79	16645603.52
10	7256198.39	16645429.52
11	7256605.35	16645435.10

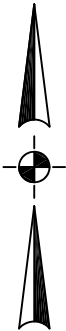

PROPERTY DESCRIPTION:

LOT 1 OF THE NORTHWEST 1/4 OF THE NORTHEAST 1/4 OF SECTION 31, TOWNSHIP 84 NORTH, RANGE 37 WEST, OF THE 5TH, P.M., CRAWFORD COUNTY, IOWA AND MORE PARTICULARLY DESCRIBED AS FOLLOWS:

BEGINNING AT THE NORTH 1/4 CORNER OF SAID SECTION 31, THENCE SOUTH 89°48'06" EAST ALONG THE NORTH LINE OF SAID NORTHWEST 1/4 OF THE NORTHEAST 1/4, 255.00 FEET; THENCE SOUTH 00°47'12" WEST, 190.00 FEET; THENCE SOUTH 08°54'17" WEST, 77.89 FEET; THENCE NORTH 89°48'06" WEST, 70.00 FEET; THENCE SOUTH 00°47'12" WEST, 173.00 FEET; THENCE NORTH 89°48'06" WEST, 174.00 FEET TO A POINT ON THE WEST LINE OF SAID NORTHWEST 1/4 OF THE NORTHEAST 1/4; THENCE NORTH 00°47'12" EAST ALONG SAID WEST LINE, 440.00 FEET TO THE POINT OF BEGINNING CONTAINING 2.24 ACRES MORE OR LESS, SUBJECT TO ANY AND ALL EASEMENTS APPARENT OR OF RECORD.

CTR SEC  
SEC 31-84-37  
FND 1/2" REBAR  
YPC BURNT

LEGEND

SURVEY	FOUND	SET
SECTION CORNER	▲	△
5/8" REBAR YPC #17979 (UNLESS NOTED)	●	○
MAG NAIL	•	◦
PLATTED DISTANCE	P	
MEASURED DISTANCE	M	
SECTION LINE	---	---

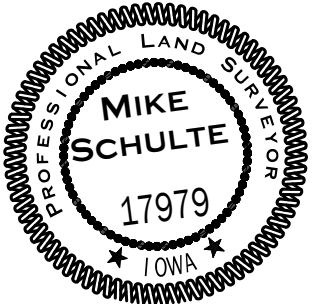

I HEREBY CERTIFY THAT THIS LAND SURVEYING DOCUMENT WAS PREPARED BY ME OR UNDER MY DIRECT PERSONAL SUPERVISION AND THAT I AM A DULY LICENSED PROFESSIONAL LAND SURVEYOR UNDER THE LAWS OF THE STATE OF IOWA.

2018/08/28  
MIKE SCHULTE  
DATE  
LICENSE NUMBER: 17979  
LICENSE RENEWAL DATE IS DECEMBER 31, 2019  
PAGES COVERED BY THIS SEAL: 1 OF 1

LOT 1 OF THE NW1/4 NE1/4 SECTION 31, T84N, R37W

SCHULTE SURVEYING, INC.

DRAWN BY: MLS  
PROJ NUMBER: 18-039  
SHEET : 1 OF 1  
SCALE: 1"=100'